



*Meridiana*

—  
**MODEL HOME  
MAP GUIDE**



# MODEL HOME PARK

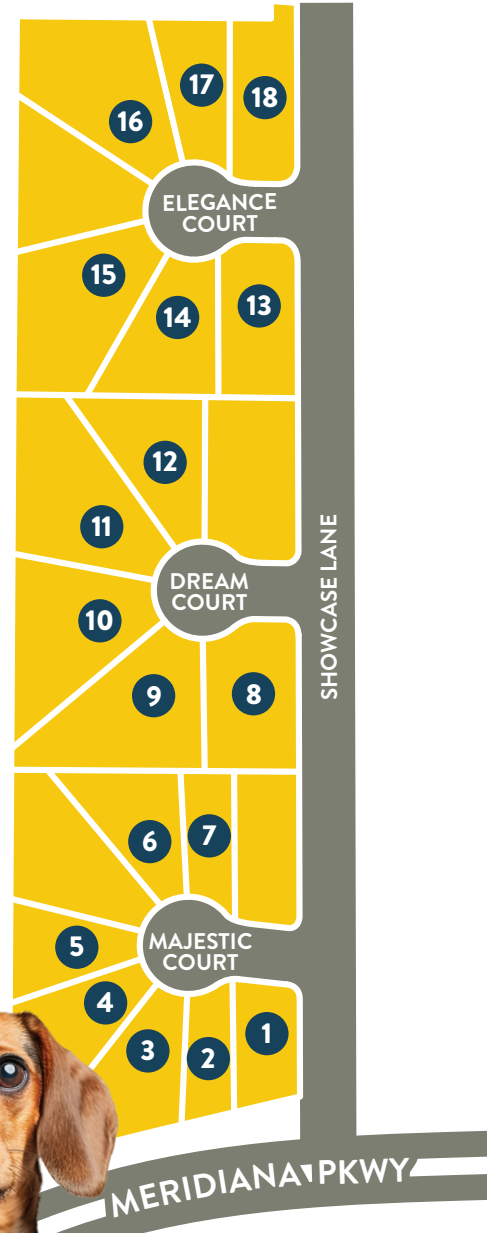

## AWARD-WINNING BUILDERS

- 1 CHESMAR HOMES — \$340s
- 2 CHESMAR HOMES COURT — \$390s
- 3 PERRY HOMES — \$370s
- 4 PERRY HOMES — \$420s
- 5 DAVID WEEKLEY HOMES — \$310s
- 6 HIGHLAND HOMES — \$340s
- 7 NEWMARK HOMES — \$330s
- 8 DREES CUSTOM HOMES — \$660s
- 9 SHEA HOMES — \$550s
- 10 PERRY HOMES — \$610s
- 11 WESTIN HOMES — \$480s
- 12 HIGHLAND HOMES — \$410s
- 13 HIGHLAND HOMES — \$560s
- 14 DREES CUSTOM HOMES — \$540s
- 15 CHESMAR HOMES — \$440s
- 16 PERRY HOMES — \$450s
- 17 DAVID WEEKLEY HOMES — \$390s
- 18 WESTIN HOMES — \$550s

\*See large map inside for more details



NEWMARK HOMES

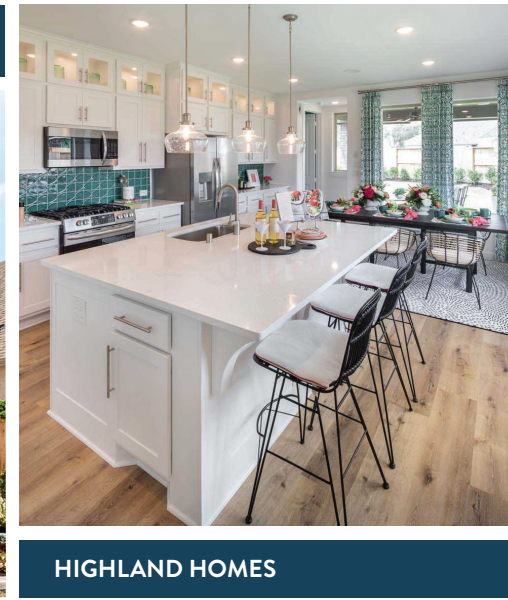

HIGHLAND HOMES

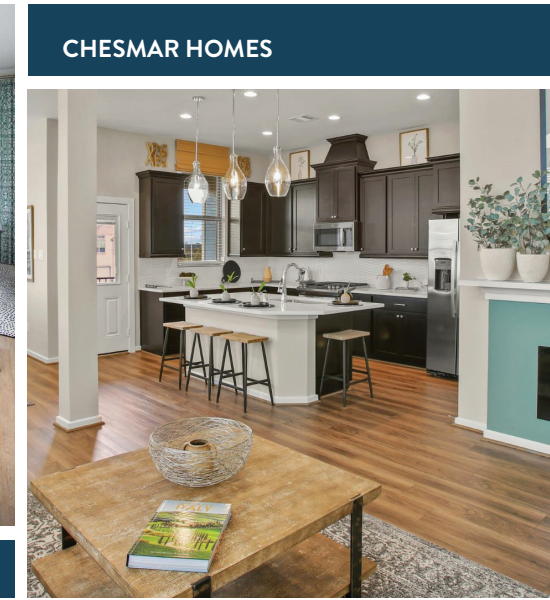

CHESMAR HOMES



PERRY HOMES

Crafted by the Best:  
**MERIDIANA LIVING**



WESTIN HOMES



SHEA HOMES



DREES CUSTOM HOMES

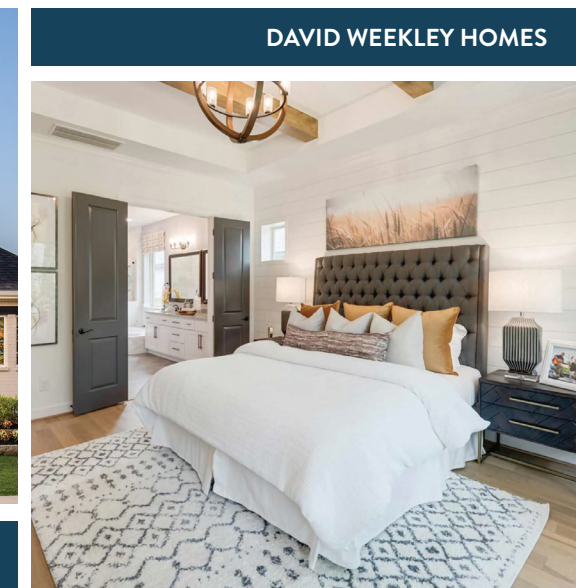

DAVID WEEKLEY HOMES





# Meridiana



### Palo Verde—\$300+

- 1 Chesmar — 29'  
5318 Majestic Court  
346.459.4659

### Constellation—\$300+

- 1 Chesmar — 28'  
5318 Majestic Court  
346.459.4659

### Spring Gardens—\$300+

- 1 Chesmar — 45'  
5318 Majestic Court  
713.503.5223

### The Townhomes Symphony Grove—\$260+

- Chesmar Homes  
4910 Anders Lane  
832.795.9797

### Forest Trails—\$280+ 45'

- 5 David Weekley — 45'  
5302 Elegance Court  
713.574.5048
- 3 Perry Homes — 45'  
5306 Elegance Court  
713.830.3197

### The Gallery — \$320+ 40'

- 7 Newmark Homes — 40'  
5311 Majestic Court  
281.000.0000
- 6 Highland Homes — 40'  
5307 Majestic Court  
281.517.9864

### Pacific Heights—\$380+ 45'

- 17 David Weekley — 45'  
5311 Elegance Court  
713.574.5048
- 16 Perry Homes — 45'  
5307 Elegance Court  
713.830.8232

### Country Meadows— \$390+ 50'

- 2 Chesmar Homes — 50'  
5314 Majestic Court  
832.431.1124
- 4 Perry Homes — 50'  
5310 Majestic Court  
713.830.3197

### Active Adult Serenity— Gated \$370+ 60'

- Tricoast Homes  
713.489.7738  
Call for details

### Brazos Grove—\$430+ 60'

- 15 Chesmar Homes  
5302 Elegance Court  
832.795.9797

### Reef Ridge—\$480+ 50'

- 12 Highland Homes  
5307 Dream Court  
281.517.9864
- 18 Westin Homes  
5315 Elegance Court  
832.937.6265

### Magnolia Estates—\$480+ 60'

- 16 Perry Homes  
5307 Elegance Court  
713.830.8232

### Zilker Meadows—\$480+ 60'

- 10 Perry Homes  
5302 Dream Court  
713.830.8234

### Midway Gardens—\$480+ 60'

- 15 Chesmar Homes  
5302 Elegance Court  
832.795.9797
- 18 Westin Homes  
5315 Elegance Court  
832.937.6265

### Alpine Meadows—\$510+ 65'

- 14 Drees Custom Homes  
5306 Elegance Court  
832.604.2751
- 13 Highland Homes  
5310 Elegance Court  
281.517.9836

### The Cascades—\$510+ 65'

- 14 Drees Custom Homes  
5306 Elegance Court  
832.604.2756
- 13 Highland Homes  
5310 Elegance Court  
832.922.2364

### Montane Grove—\$550+ 70'

- 10 Perry Homes  
5302 Dream Court  
713.830.8234
- 9 Shea Homes  
5306 Dream Court  
832.869.4032

### Lake Vista— Gated \$640+ 80'

- 8 Drees Custom Homes  
5310 Dream Court  
832.604.2751
- 10 Perry Homes  
5302 Dream Court  
713.830.8234

### Oak Park— Gated \$740+ 100'

- 8 Drees Custom Homes  
5310 Dream Court  
832.604.2751

### Everest Estates— Gated \$740+ 100'

- 8 Drees Custom Homes  
5310 Dream Court  
832.604.2751

JUST OFF 288 10 MINUTES FROM PEARLAND TOWN CENTER

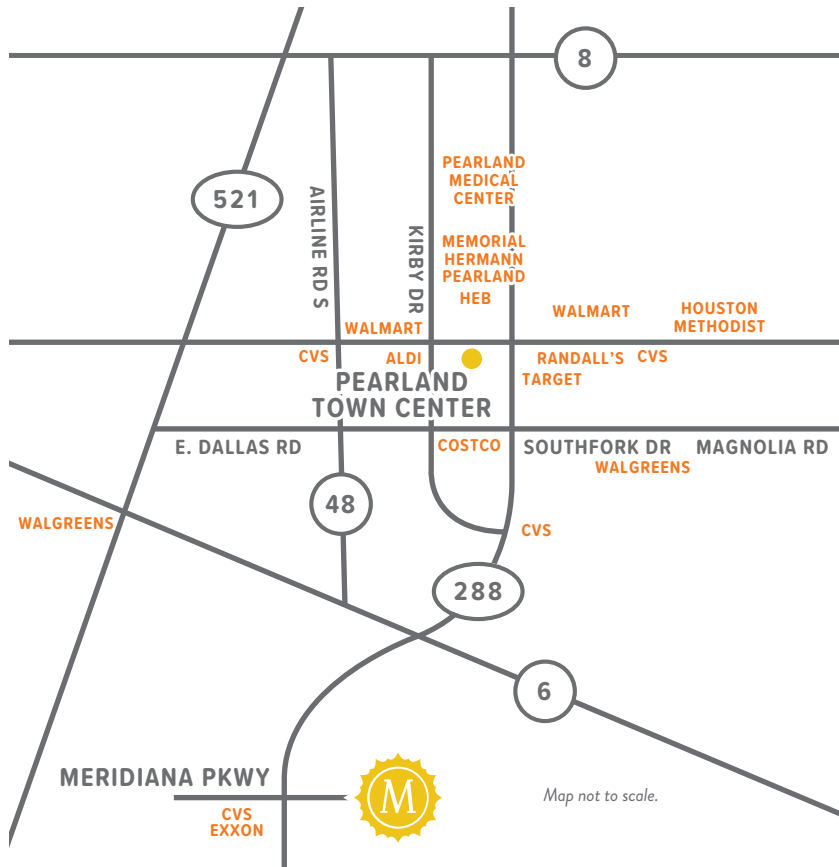

**STAY IN THE KNOW!**

*Text 4003 to 281.915.5515 to receive updates on all things Meridiana!*

**START YOUR TOUR**

*at the Oasis Village & Welcome Center*

**MERIDIANATEXAS.COM**

281.915.5515 | 4003 Meridiana Parkway, Iowa Colony, TX 77583

Mon - Sat 10am - 6pm • Sun Closed



©2025 Rise Communities. Prices subject to change. The maps are for illustration purposes only, based upon current development concepts, which are subject to change without notice. No guarantee is made that the features depicted will be built, or, if built, will be as depicted. There is no assurance of future development or that it will be developed as shown. Photographs shown do not always depict actual locations/features in the Community. Prices, specifications, details, and availability of a Builder's new homes are subject to change without notice. 4/25.





# MODEL HOME PARK

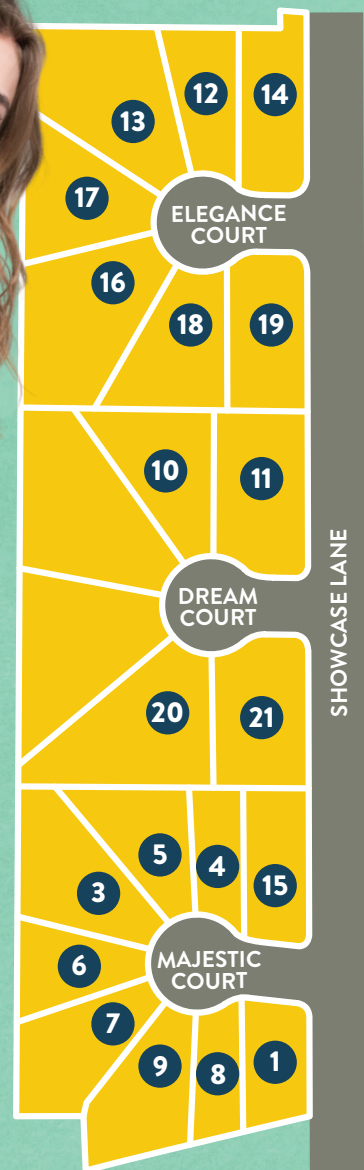

SHOWCASE LANE

MERIDIANA PKWY

## AWARD-WINNING BUILDERS

- 1 CHESMAR HOMES — \$250s
- 2 CHESMAR HOMES COURT — \$320s
- 3 NEWMARK HOMES — \$320s
- 4 HIGHLAND HOMES — \$340s
- 5 DAVID WEEKLEY HOMES — \$300s
- 6 PERRY HOMES — \$360s
- 7 CHESMAR HOMES — \$390s
- 8 PERRY HOMES — \$410s
- 9 HIGHLAND HOMES — \$440s
- 10 TOLL BROTHERS — \$360s
- 11 DAVID WEEKLEY HOMES — \$390s
- 12 PERRY HOMES — \$450s
- 13 WESTIN HOMES — \$480s
- 14 TRICOAST HOMES (55+) — \$370s
- 15 CHESMAR HOMES — \$430s
- 16 WESTIN HOMES — \$550s
- 17 DREES CUSTOM HOMES — \$640s
- 18 HIGHLAND HOMES — \$560s
- 19 PERRY HOMES — \$600s
- 20 SHEA HOMES — \$550s
- 21 DREES CUSTOM HOMES — \$740s

\*See large map inside for more details



NEWMARK HOMES



HIGHLAND HOMES

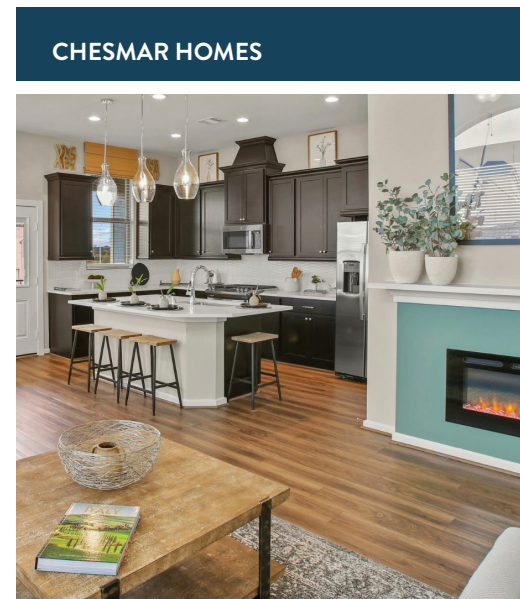

CHESMAR HOMES



PERRY HOMES

# Crafted by the Best: MERIDIANA LIVING



WESTIN HOMES



TOLL BROTHERS



DREES CUSTOM HOMES



DAVID WEEKLEY HOMES



# MODEL HOME PARK

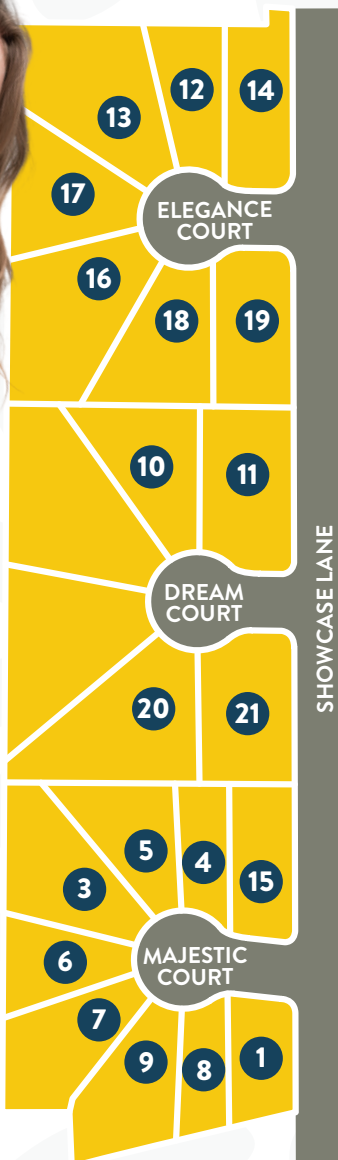

MERIDIANA PKWY

# AWARD-WINNING BUILDERS

- 1 CHESMAR HOMES — \$250s
- 2 CHESMAR HOMES COURT — \$320s
- 3 NEWMARK HOMES — \$320s
- 4 HIGHLAND HOMES — \$340s
- 5 DAVID WEEKLEY HOMES — \$300s
- 6 PERRY HOMES — \$360s
- 7 CHESMAR HOMES — \$390s
- 8 PERRY HOMES — \$410s
- 9 HIGHLAND HOMES — \$440s
- 10 TOLL BROTHERS — \$360s
- 11 DAVID WEEKLEY HOMES — \$390s
- 12 PERRY HOMES — \$450s
- 13 WESTIN HOMES — \$480s
- 14 TRICOAST HOMES (55+) — \$370s
- 15 CHESMAR HOMES — \$430s
- 16 WESTIN HOMES — \$550s
- 17 DREES CUSTOM HOMES — \$640s
- 18 HIGHLAND HOMES — \$560s
- 19 PERRY HOMES — \$600s
- 20 SHEA HOMES — \$550s
- 21 DREES CUSTOM HOMES — \$740s

\*See large map inside for more details



Crafted by the Best:  
**MERIDIANA LIVING**

